

## Q: How can I activate my WiFi account ?

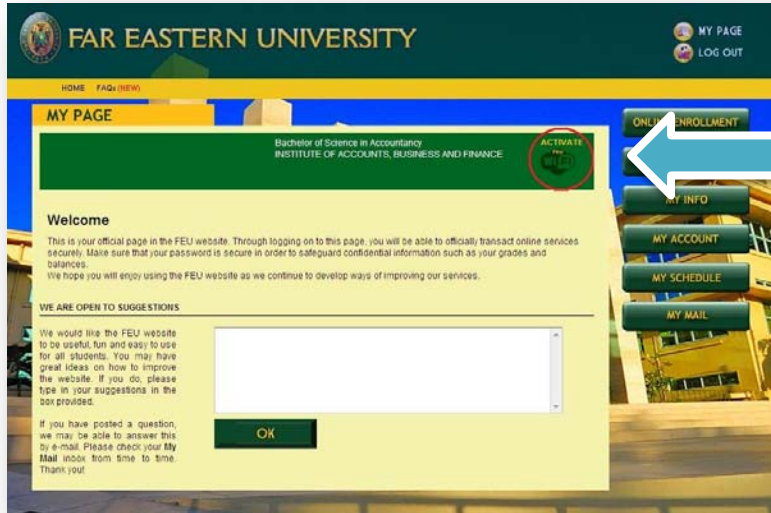

If your WiFi account is not yet active, this icon will appear at your student portal page.

Just fill-up the activation/survey form and wait for three working days for your access to be enabled.



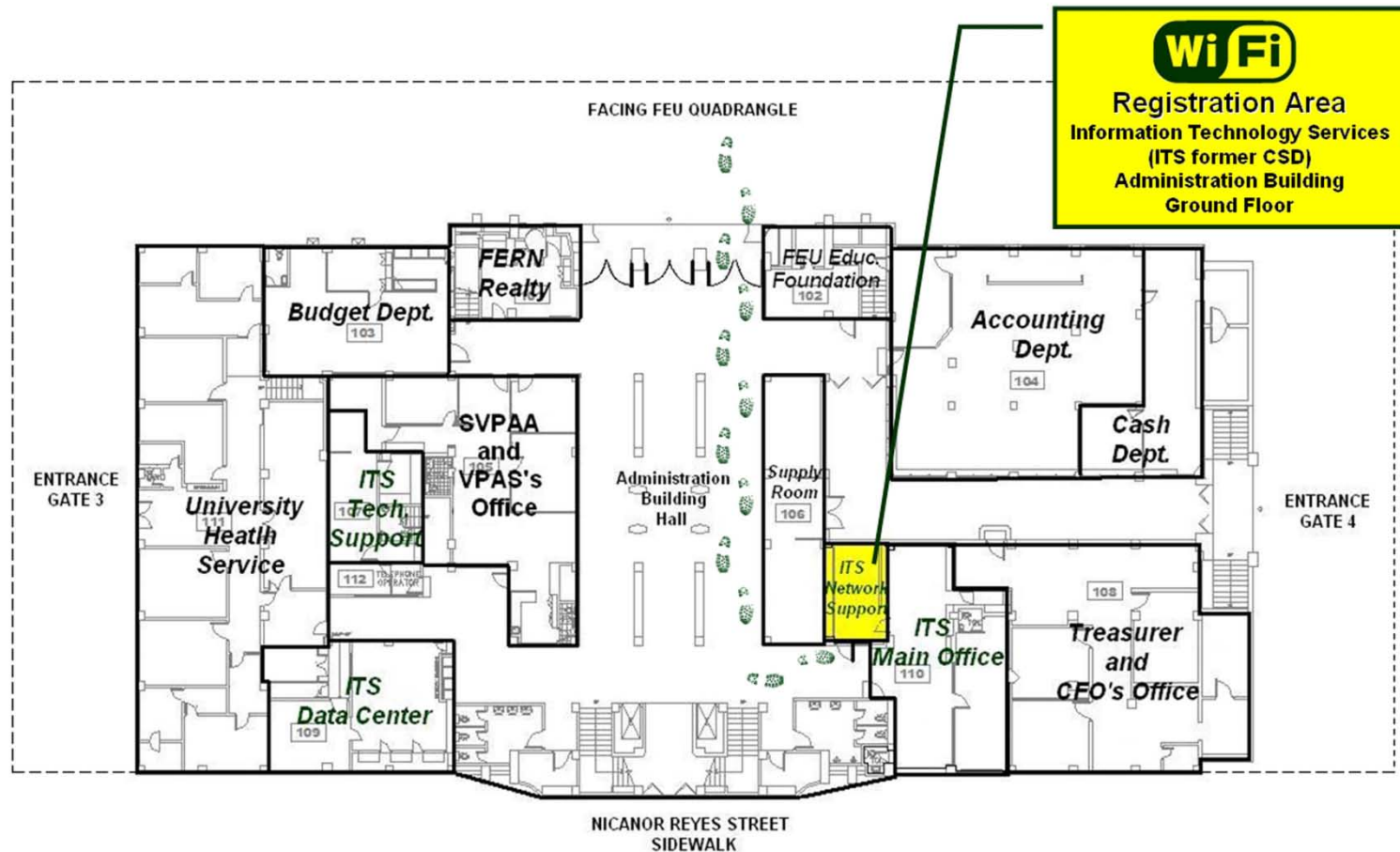

If you need immediate activation or assistance with your device, you may also visit the network registration area located at Administration Building, Ground Floor on Mondays & Wednesdays from 1:30 to 4:30 PM.